



Knurled Press-Fit Plungers

Quality | Precision | Reliability

Setting the Highest Standards for Spring Loaded Devices

Just as Vlier's name has stood for the highest in Quality, Value, Service and Selection for more than 70 years... the Vlier Spring Loaded Devices have stood apart having the highest in Quality, Precision and Reliability with the very first "Vlier Pin". Now Vlier has once again taken that proven and trusted technology to an even higher level with a newly designed Knurled Press-Fit Plunger and Ball Plunger. These new designs offer greater flexibility than ever before for manufacturing and product design without the use of threads, locking elements and bonding agents for a secure fit. The beauty of the design is in its simplicity and function giving designers more options than ever before.

Special Features:

- > Simple, efficient installation
- > No thread adjustment
- > Stainless Steel option resists corrosion
- > Stainless Steel withstands high temperature applications
- > Nylon Ball and Delrin Plunger available
- > Heavy Spring Force and Light Spring Force options

Each of our "Vlier Pins" is engineered to reduce cost, increase productivity and perform reliably. Vlier Products are precision made, utilizing the finest material for everything we manufacture giving you the confidence to use in your application. You can depend on Vlier products to do the job right.

Call your Authorized VLIER dealer or contact us at (800) 821-1090 or visit us on the web at www.vlier.com

Steel



Stainless Steel



Please visit us at: www.vlier.com
or call toll free (800) 821-1090

Always Insist on Vlier Parts

Plunger



*Knurl $\varnothing, A \pm 0.10$

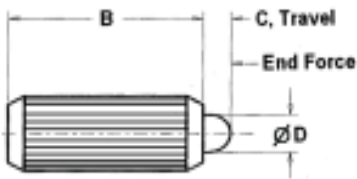

BALL PLunger



*Knurl $\varnothing, A \pm 0.10$

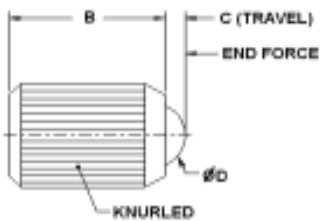

Shoulderless KNURLED Press Fit Plunger

Steel:	Stainless Steel:	Hole Size Diameter	END FORCES, lbs		Knurl \varnothing, A^* in	Body Length, B in	Proj, C in	PLUNGER Dia, D in
			INITIAL	FINAL				
PFPK52	SPFPK52	$\varnothing.203''$ (13/64)	1.5	4.5	.215	0.50	0.094	0.121
PFPK54	SPFPK54	$\varnothing.250''$ (1/4)	2.5	6.0	.259	0.58	0.125	0.168
PFPK58	SPFPK58	$\varnothing.375''$ (3/8)	5.0	14.0	.384	0.90	0.187	0.234
PFPK60	SPFPK60	$\varnothing.500''$ (1/2)	8.0	18.0	.509	1.25	0.250	0.332

WITH DELRIN NOSE:

DPFPK52	DSPFPK52	$\varnothing.203''$ (13/64)	1.5	4.5	.215	0.50	0.094	0.121
DPFPK54	DSPFPK54	$\varnothing.250''$ (1/4)	2.5	6.0	.259	0.58	0.125	0.168
DPFPK58	DSPFPK58	$\varnothing.375''$ (3/8)	5.0	14.0	.384	0.90	0.187	0.234
DPFPK60	DSPFPK60	$\varnothing.500''$ (1/2)	8.0	18.0	.509	1.25	0.250	0.332

Light End Force

PFPK51	SPFPK51	$\varnothing.203''$ (13/64)	0.75	2	.215	0.50	0.094	0.121
PFPK53	SPFPK53	$\varnothing.250''$ (1/4)	1.25	3	.259	0.58	0.125	0.168
PFPK57	PFPK57	$\varnothing.375''$ (3/8)	2.5	7	.384	0.90	0.187	0.234
PFPK59	SPFPK59	$\varnothing.500''$ (1/2)	4	9	.509	1.25	0.250	0.332

WITH DELRIN NOSE:

DPFPK51	DSPFPK51	$\varnothing.203''$ (13/64)	0.75	2	.215	0.50	0.094	0.121
DPFPK53	DSPFPK53	$\varnothing.250''$ (1/4)	1.25	3	.259	0.58	0.125	0.168
DPFPK57	DSPFPK57	$\varnothing.375''$ (3/8)	2.5	7	.384	0.90	0.187	0.234
DPFPK59	DSPFPK59	$\varnothing.500''$ (1/2)	4	9	.509	1.25	0.250	0.332

Shoulderless KNURLED Press Fit BALL Plunger

Steel:	Stainless Steel:	Hole Size Diameter	END FORCES, lbs		Knurl \varnothing, A^* in	Body Length, B in	Proj, C in	PLUNGER Dia, D in
			INITIAL	FINAL				
PFBK48	SPFBK48	$\varnothing.141''$ (9/64)	0.75	2.5	.153	.290	0.035	0.094
PFBK52	SPFBK52	$\varnothing.203''$ (13/64)	2.00	5.0	.215	.435	0.058	0.156
PFBK54	SPFBK54	$\varnothing.250''$ (1/4)	3.0	7.0	.259	.520	0.070	0.188
PFBK56	SPFBK56	$\varnothing.312''$ (5/16)	4.0	10.0	.321	.700	0.090	0.250
PFBK58	SPFBK58	$\varnothing.375''$ (3/8)	5.0	14.0	.384	.865	0.110	0.313
PFBK60	SPFBK60	$\varnothing.500''$ (1/2)	8.0	18.0	.509	1.210	0.161	0.437

WITH NYLON BALL:

DPFBK48	DSPFBK48	$\varnothing.141''$ (9/64)	0.75	2.5	.153	.290	0.035	0.094
DPFBK52	DSPFBK52	$\varnothing.203''$ (13/64)	2.00	5.0	.215	.435	0.058	0.156
DPFBK54	DSPFBK54	$\varnothing.250''$ (1/4)	3.0	7.0	.259	.520	0.070	0.188
DPFBK56	DSPFBK56	$\varnothing.312''$ (5/16)	4.0	10.0	.321	.700	0.090	0.250
DPFBK58	DSPFBK58	$\varnothing.375''$ (3/8)	5.0	14.0	.384	.865	0.110	0.313
DPFBK60	DSPFBK60	$\varnothing.500''$ (1/2)	8.0	18.0	.509	1.210	0.161	0.438

Light End Force

PFBK47	SPFBK47	$\varnothing.141''$ (9/64)	0.4	1.3	.153	.290	0.035	0.094
PFBK51	SPFBK51	$\varnothing.203''$ (13/64)	1.0	2.5	.215	.435	0.058	0.156
PFBK53	SPFBK53	$\varnothing.250''$ (1/4)	1.5	3.5	.259	.520	0.070	0.188
PFBK55	SPFBK55	$\varnothing.312''$ (5/16)	2.0	5.0	.321	.700	0.090	0.250
PFBK57	SPFBK57	$\varnothing.375''$ (3/8)	2.5	7.0	.384	.865	0.110	0.313
PFBK59	SPFBK59	$\varnothing.500''$ (1/2)	4.0	9.0	.509	1.210	0.161	0.438

WITH NYLON BALL:

DPFBK47	DSPFBK47	$\varnothing.141''$ (9/64)	0.4	1.3	.153	.290	0.035	0.094
DPFBK51	DSPFBK51	$\varnothing.203''$ (13/64)	1.0	2.5	.215	.435	0.058	0.156
DPFBK53	DSPFBK53	$\varnothing.250''$ (1/4)	1.5	3.5	.259	.520	0.070	0.188
DPFBK55	DSPFBK55	$\varnothing.312''$ (5/16)	2.0	5.0	.321	.700	0.090	0.250
DPFBK57	DSPFBK57	$\varnothing.375''$ (3/8)	2.5	7.0	.384	.865	0.110	0.313
DPFBK59	DSPFBK59	$\varnothing.500''$ (1/2)	4.0	9.0	.509	1.210	0.161	0.438